

NORTHERN PACIFIC RAILWAY COMPANY

Manitoba Division

Auditor's No.

Superintendent's No. 116

To Mr. M. C. Kimberly

Gen'l Sup't., St. Paul.

I respectfully recommend the improvement described below, and request special appropriation to cover cost of same:

- 1. Location (with regard to nearest station) St. Arathe East head block ft. West of N. P.
- 2. Title. (Side Tracks and Spurs to be named) Spur track 500 ft.
- 3. Description. (Give description of proposed New Work. If Sidings or Spurs, make sketch below showing Points of Connection, if Standard Building, no description is necessary, but give Plan Nos.)

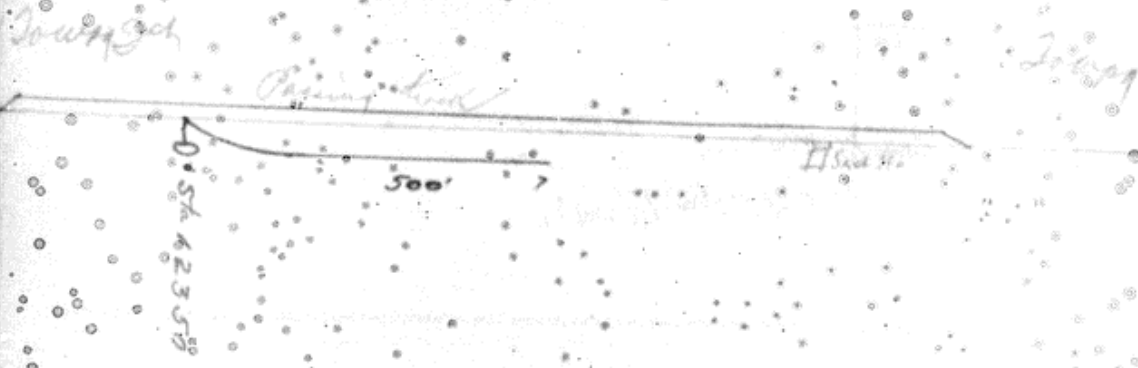

- 4. New Work, Additions or Repairs New Work
- 5. Necessity for proposed Work: (If increase of business, give particulars.)

To be used as an elevator track, and to avoid leaving cars on passing track for loading and consequent additional switching and delay to trains.
- 6. Is Improvement on Right-of-way or Land owned by this Company? Company property

If not, what can be done to secure Title?
- 7. Estimate of Cost: Material (as itemized on next page) \$325.00 Labor \$ 75.00 Total \$ 400.00
- 8. Work should be commenced in order to
- 9. Length of Time required to complete Work
- 10. Remarks: (Note here if any Material or Labor is to be furnished by outside parties, and whether work should be done by contract or other Company men.)

Chief Engineers Office

Division Engineer.

Handwritten signature and initials

Superintendent.