

1091 P 12/24  
1898 0-17 97 EN P  
**NORTHERN PACIFIC RAILWAY COMPANY.**

Auditor's No. 240.

**MONTANA** -

Division.

Superintendent's No. **78.**

**Livingston, Mont. Nov. 26th, 1898.** 189

To **W. F. Pearce, Esq.**

**Asst. Genl. Superintendent.**

I respectfully recommend the improvement described below, and request special appropriation to cover cost of same:

1. Location (with regard to nearest station) **Laurel** East head block \_\_\_\_\_ ft. West of M. P. \_\_\_\_\_
2. Title: (Side Tracks and Spurs to be named) **Revision of Yard.**
3. Description. (Give description of proposed New Work. If Siding or Spur, make Sketch below showing Points of Compass; if Standard Building, no description is necessary, but give Plan Nos.)

**-SEE BLUE PRINT ATTACHED-**

4. New Work, Additions or Repairs **New.**
5. Necessity for proposed Work: (If increase of Business, give particulars.) **To handle prospective business of Rocky Fork Branch, due to opening of coal mines at Carbon, Gebo and Widger.**
6. Is Improvement on Right-of-way or Land owned by this Company? **Yes.**  
If not, what can be done to secure Title? \_\_\_\_\_
7. Estimate of Cost: Material (as itemized on next page) **9200.00** Labor **5800.00** Total **15000.00**
8. Work should be commenced **At once.** in order to **Complete before** \_\_\_\_\_  
**ground freezes.**
9. Length of Time required to complete Work **One month.**
10. Remarks: (Note here if any Material or Labor is to be furnished by outside parties, and whether work should be done by contract or with Company force.)

**- NO -**

Chief Engineers Office.

12/14/98 ..... 3.....

*Chas. B. Rice*

Division Engineer.

12/4 1898

*W. F. Pearce* 12/1/98

Superintendent.

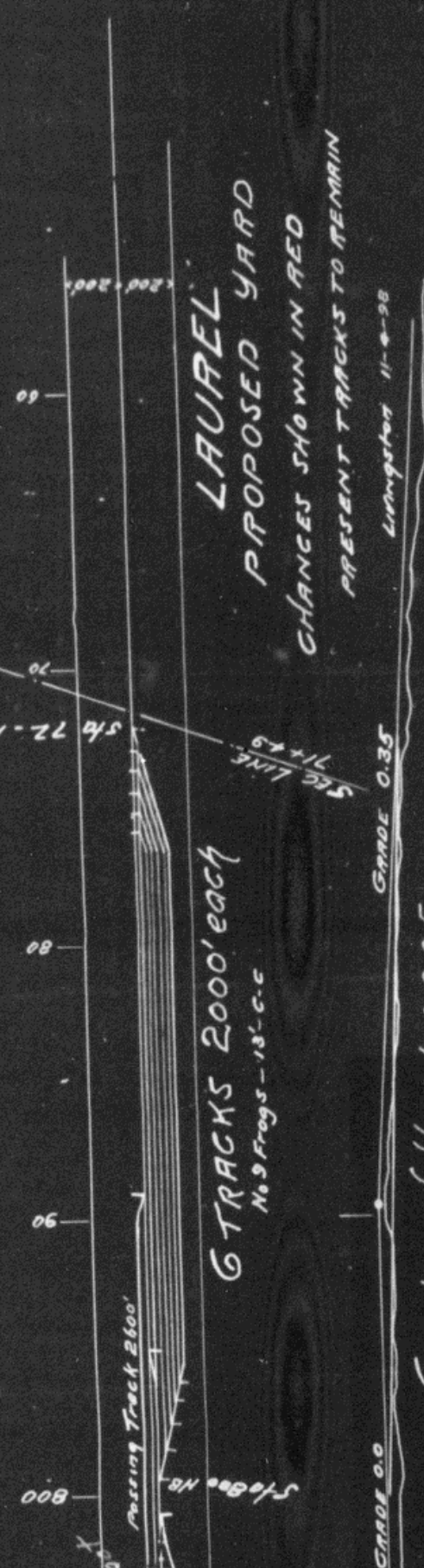

LAUREL

PROPOSED YARD

CHANGES SHOWN IN RED

PRESENT TRACKS TO REMAIN

Livingston 11-8-98

6 TRACKS 2000' each

No. 9 Frogs - 18' C.C.

Grade of Yard 0.225

GRADE 0.35

5th 72 - XA

SEC LINE 71+49

Passing Track 2600'

800

90

80

70

60

200' 200''

GRADE 0.0

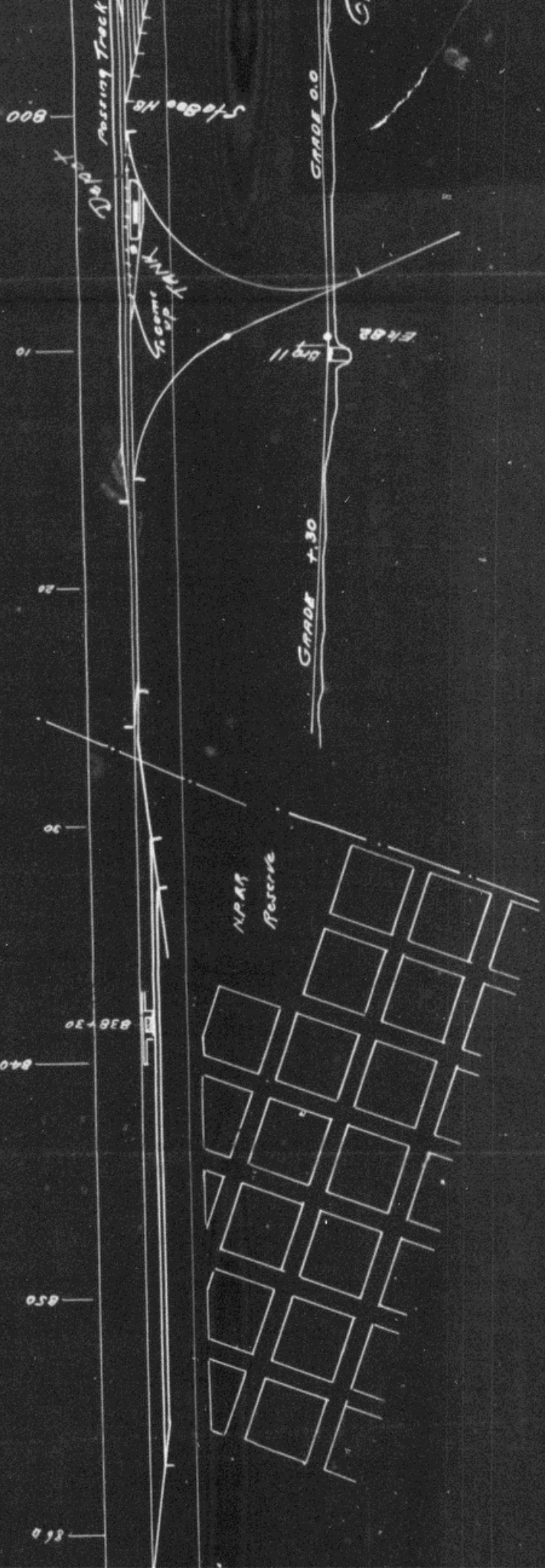

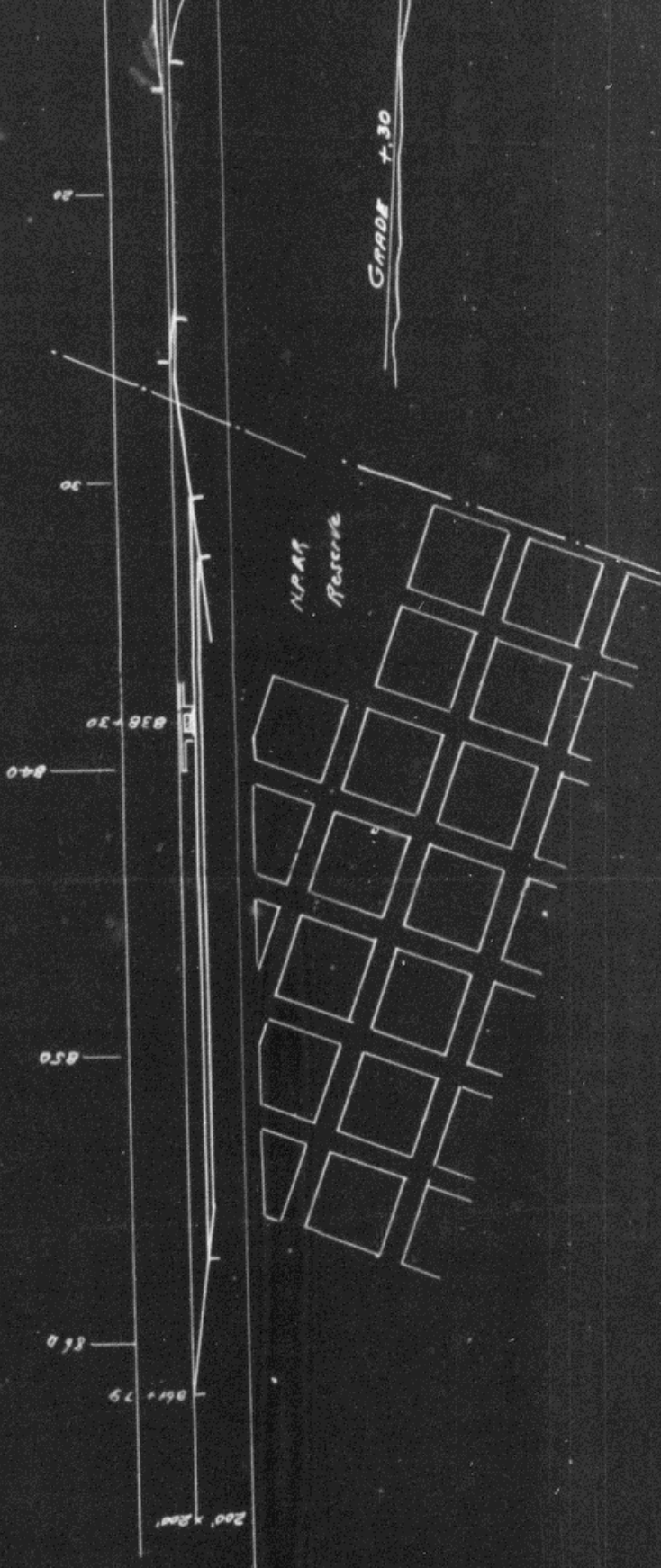

Folio # 17