

MP
RFA No.

AUTHORITY

Acquisition dated **March 19,**

E. D. No. **23**
Form 1200-2
(Rev. 1-1-00)

From **Seattle Terminals Division**

Comptroller's No. **350**

Operating Department.

For **Lake, Washington, 386' spur for Chittenden Logging Co.**

Amount, \$ **335.00**

REMARKS AND RECOMMENDATIONS.

Northern Pacific to furnish metal only; applicant to pay all other cost and furnish easement. This to cover connection with the Chittenden Logging Co's logging road and serve a proposed rollway which the Logging Co. intend to build. They expect to operate for three years over this rollway and after that time propose to utilize the spur and their logging road as an industrial track.

Operating Expenses	-	\$	_____
Additions and Betterments	} Sect. No. 15	\$	335.00
		" "	\$ _____
		" "	\$ _____

W. C. Smith
Chief Engineer of Maintenance of Way.
19630

D. P. Beach
Engineer Maintenance of Way.

Chief Engr., Mech. Supt. or Supt. Telegraph.

[Signature]
General Manager.

[Signature]
Third Vice-President.

[Signature]
Second Vice-President.

DISTRIBUTION OF CHARGES.

Operating Expenses	_____	\$	_____
Additions and Betterments	L. C. C. Sect. No. _____	\$	335.00
" " " " "	" " " " "	\$	_____
" " " " "	" " " " "	\$	_____
" " " " "	" " " " "	\$	_____

Total, \$ _____

[Signature]
Comptroller.

NOTICE DEPOSITED BY CO.
RECEIVED
JUN 21 1910

Approved _____ 19

JUN 20 1910

[Signature]
President.

COMPTROLLER'S RECORD OF NOTICE OF APPROVAL AND OF COMPLETION.

Form 1345 issued

Work commenced

19

Work completed

19

19

L 6935

N.P.R.
SEATTLE TERM. DIX
near LA VILLA, WASH.
Sketch showing proposed spur
for Chittenden Logging Company.

Office Engr. M. G. W.
Tacoma Wash. Nov. 16, 1910
Scale 1" = 100'

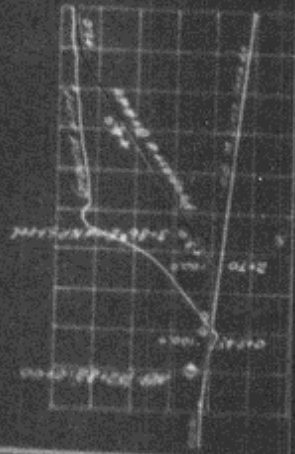

Profile

SE 4, 5, 6, 27, T26N R4E
NE 1, 3, 4, 34

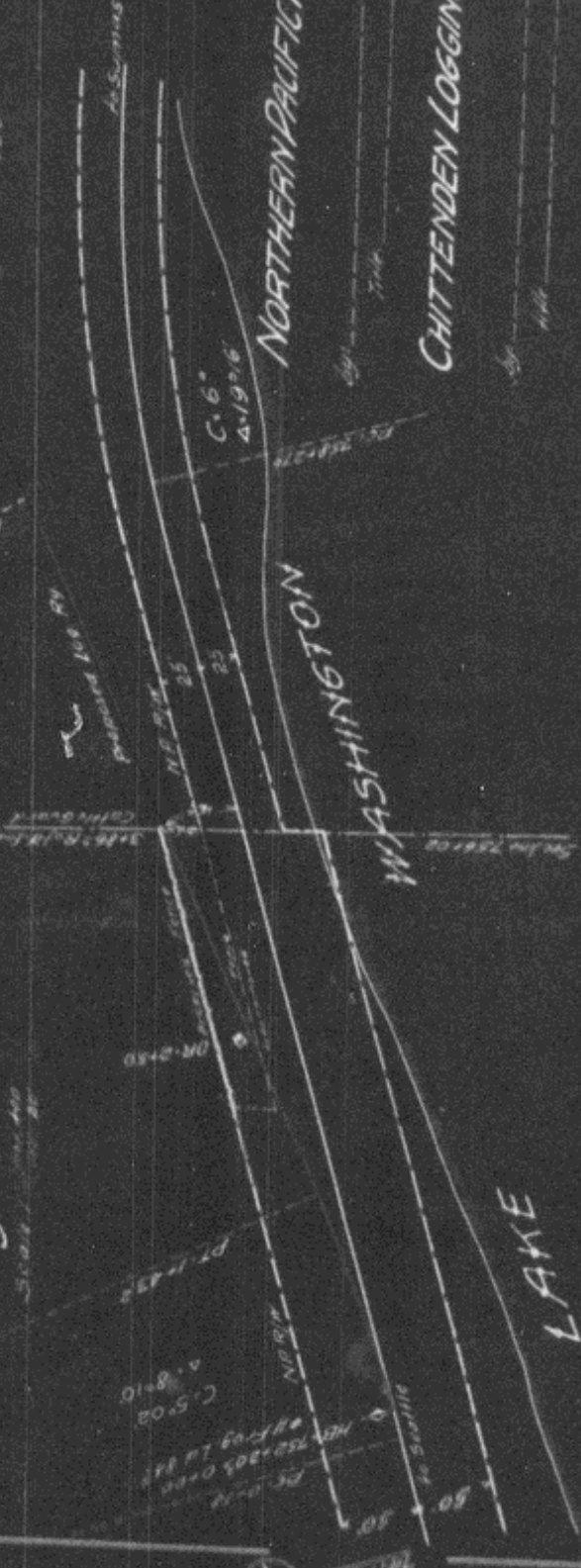

14

Correct

Note:
Existing lines owned by N.P.R.
Proposed spur owned by Chittenden Logging Co.
Proposed logging lake owned by Chittenden Logging Co.

Engr. M. G. W. 11/16/10