

NORTHERN PACIFIC RAILWAY COMPANY
AUTHORITY FOR EXPENDITURE

Year: 1922 **1923**

Superintendent's No. 188
No.

Dept. No. Engineering Dept. No. 189

A. F. E. No. 40

Rocky Mountain Div. Third District State Montana Val. Sec. No. 5

AUTHORITY IS REQUESTED FOR A NET EXPENDITURE OF \$169

Accounting distribution as follows: (Distribution to be made in General Office)

	Operating Expenses	Profit and Loss	Net Operating Expenses	Net Profit and Loss
Cost of property retired	\$ 113	\$	\$	\$
Value of salvage	41		72	
Incidental costs			210	
Total to Operating Expenses				\$ 282
Total to Profit and Loss				41
To Material and Supplies				
To Bills for Collection				
To Other Accounts				
Net charge to investment account—Additions and Betterments				113
Total of distribution				\$ 210

DEPRECIATION
DUPLICATE
EXHIBIT

Original Made with Adjustment 1923
Class of Work: No. 10

Budget reference: Not in Budget

Joint facility contract reference: Not Joint Account

The location is - - - on this company's property. To secure rights, it will be necessary

Location: Missoula, Montana.

Title Proposed track changes near Rose Avenue to accommodate trucking to team tracks.

Reason: Our commercial tracks at Missoula, known as the Rose Avenue team tracks, are too close together to permit teams to drive to, except at the east end, and there is no outlet at the west end, making it very inconvenient for our patrons in the unloading of freight.

In order to provide proper driveway and increase the capacity of the team tracks it is desired to make changes as shown.

Checked and Entered
President's Office

Work to be done by company force under charge of ~~superintendent~~ Division Superintendent.

Accounting to concentrate in the office of Superintendent, Missoula.

Signature and Title: *J.P. Baillie* Superintendent. Date November 21st, 19 22

APPROVED: <i>J.P. Baillie</i> General Superintendent.	<i>Bernard Olson</i> Engr. Maint. of Way.	<i>Wm. M. ...</i> Assistant General Manager.
<i>W. H. ...</i> Mech. Supt., Supt. Teigh. or Signal Engr.	<i>W. H. ...</i> Chief Engineer.	<i>Wm. M. ...</i> General Manager.
<i>W. H. ...</i> General Auditor or Comptroller.	<i>Charles ...</i> President.	Date of Final Approval { 11 20 22 } 19

COMPTROLLER'S RECORD OF NOTICE OF APPROVAL AND OF COMPLETION

Form No. 1345 issued JAN 24 1923 Work begun.....19..... Work finished *April 5, 1923*

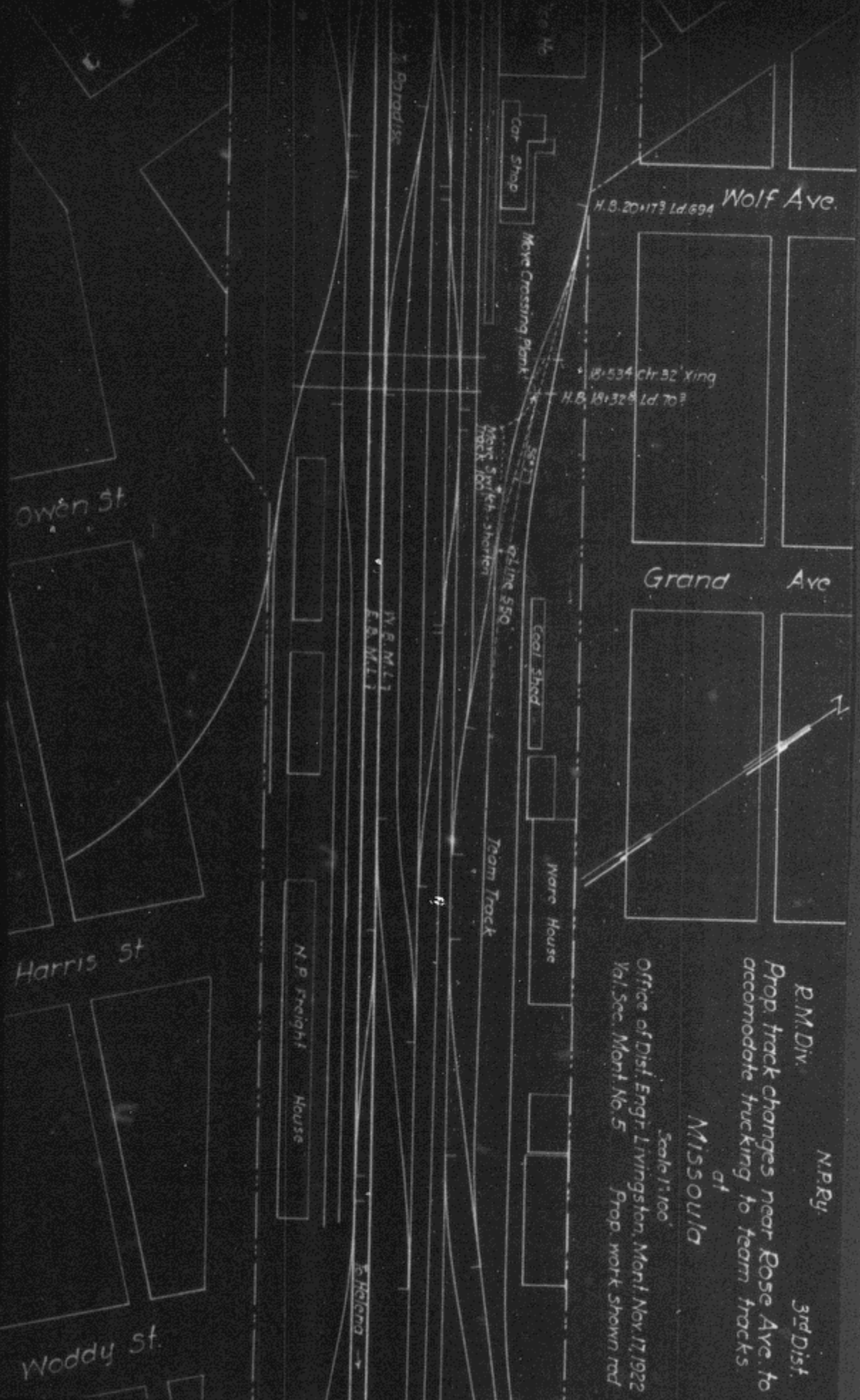

R.M. Div. N.P. Ry. 3rd Dist.

Prop. track changes near Rose Ave. to accommodate trucking to team tracks

of
Missoula

Office of Dist. Engr. Livingston, Mont. Nov. 17, 1922
Val. Sec. Mont. No. 5 Prop. work shown red

Scale 1"=100'

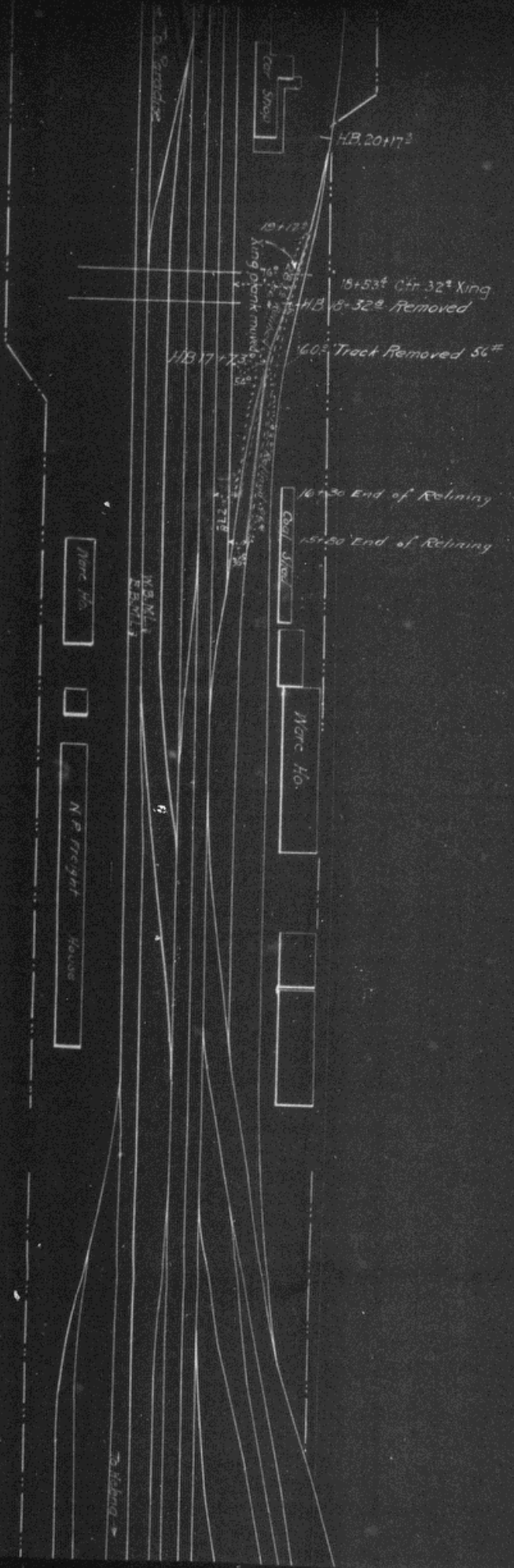

RMDV
 Track changes near Rose Ave
 N.P.R.
 3rd Dist

Office of District Engineer Livingston, Mont 5-18-23
 Scale 1"=100'
MISSOURI

Calculation section
 Montona No. 5
 Authorized under Imp. No. 40 dated 1-20-23
 No. K-beaur April 1923
 Work completed April 5, 1923