

Form 1345 **1922**

COMPTROLLER'S COPY

NORTHERN PACIFIC RAILWAY COMPANY

AUTHORITY FOR EXPENDITURE

Year: **1922**

Superintendent's No.
No.

Dept. No.
Engineering Dept. No. **11(22)**

A. F. E. No. **47**

Paget Sound Div. **Seattle Terminal** District **State** **Wash.** Val. Sec. No. **8**

AUTHORITY IS REQUESTED FOR A NET EXPENDITURE OF \$ 00

Accounting distribution as follows: (Distribution to be made in General Office.)

	Operating Expenses	Profit and Loss	Net Operating Expenses	Net Profit and Loss
Cost of property retired	\$	\$	\$	\$
Value of salvage				
Incidental costs				
Total to Operating Expenses				\$
Total to Profit and Loss				
To Material and Supplies				
To Bills for Collection				340
To Other Accounts				
Net charge to investment account—Additions and Betterments				
Total of distribution				\$ 340

DEPRECIATION DOCUMENT 15190 ENTERED ON EXHIBIT E

Budget reference: *Not in Budget*

Class of Work: No. *10*

Joint facility contract reference: *Not joint*

The location is _____ on this company's property. To secure rights, it will be necessary

Location: **Seattle, Wash.**

Title **Shift crossover at 15th Avenue N.W. - 140 ft. west.**

Reason: Under agreement between Northern Pacific Railway Co. and Great Northern Railway, of date October 11th, 1921, the crossover at 15th Avenue N.W. (Ballard) is to be shifted 140 feet westerly to afford Great Northern Railway access to the Pacific Coast Wood Pipe Spur. Entire cost to be borne by Great Northern Railway Co.

Original Cost Adjustment Made in 1922 3000

Checked and Entered President's Office

COMPTROLLER'S RECORD

Work to be done by ~~company force~~ under charge of **Division Superintendent**

Accounting to concentrate in the office of **Division Superintendent**

Signature and Title: *J. McLaughlin, Supt.* Date **December 9th, 1921.**

APPROVED: *[Signature]* General Superintendent. *[Signature]* Prin. Asst. Engr. or *[Signature]* Assistant General Manager.

Mech. Supt., Supt. Telgr. or Signal Engr. *[Signature]* Chief Engineer. *[Signature]* General Manager. *[Signature]* Vice President.

[Signature] General Auditor or Comptroller. *[Signature]* Charles J. Donnelly, President. Date of Final Approval } **JAN 2 1922** 19

COMPTROLLER'S RECORD OF NOTICE OF APPROVAL AND OF COMPLETION

Form No. 1345 issued **JAN 27 1922** Work begun _____ 19 _____ Work finished *Jan 8, 1923*

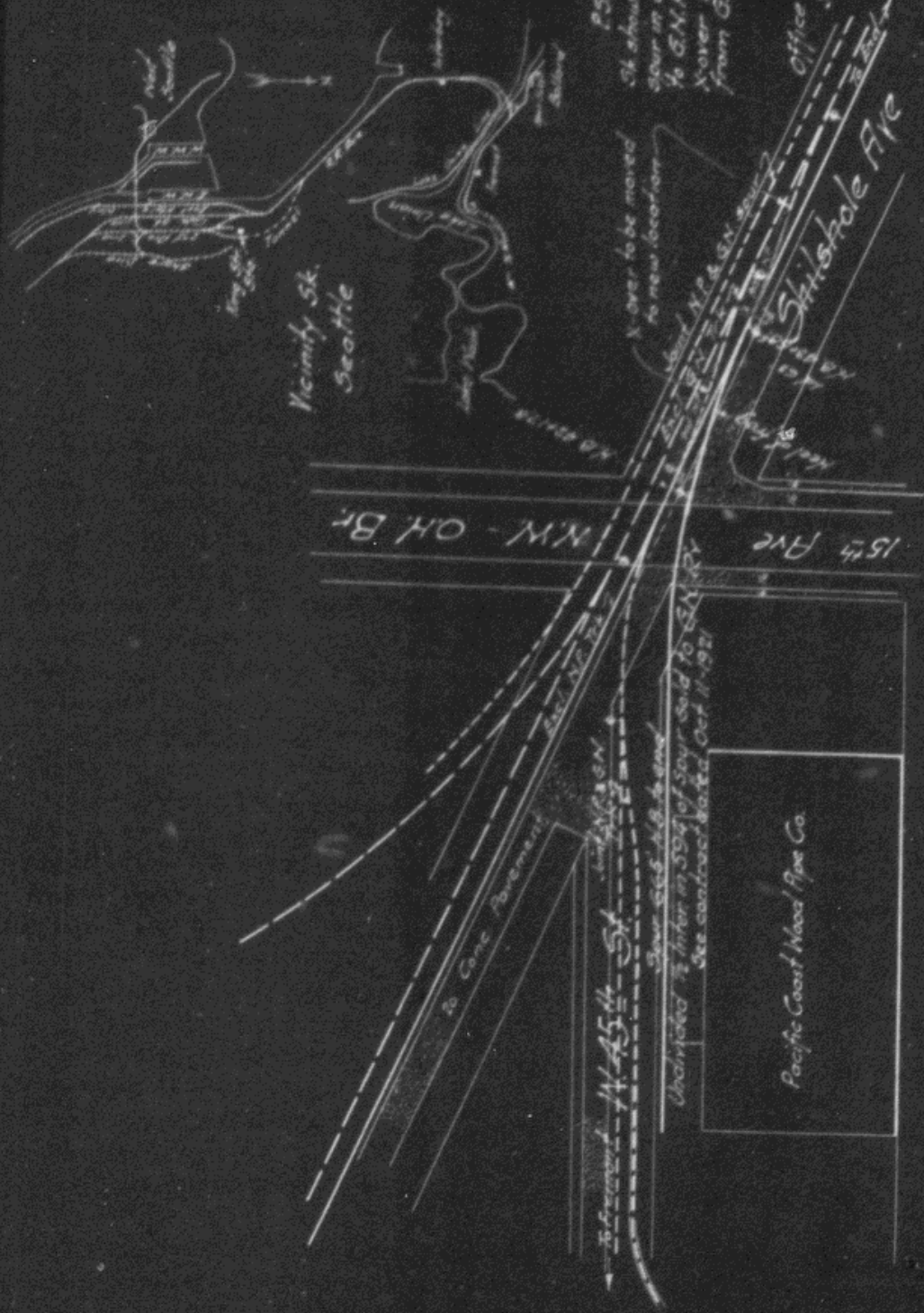

N.P.R.Y.
 P.S. Div. - Ballard Line
 It showing portion of Pac Coast Pipe Co.
 spur in which if interest has been sold
 to G.N. Ry and necessary moving of
 X-over to provide direct moving of
 from G.N. to Pipe Co's spur.

BALLARD
 Office Pine Bluff Eng. J.C. W.R.
 Scale 1" = 100' 12-8-21

Notes
 Wash. Vol. Sec. #8