

1923

COMPTROLLER'S COPY

**NORTHERN PACIFIC RAILWAY COMPANY**  
**AUTHORITY FOR EXPENDITURE**

1923

Year: 1923

Superintendent's No. **1** Dept. No. **Engineering Dept. No. 19(23)**  
 No. **Engineering Dept. No. 19(23)** A. F. E. No. **85**  
**IDAHO** Div. **P&L** District State **WASH** Val. Sec. No. 11  
 Branch

**AUTHORITY IS REQUESTED FOR A NET EXPENDITURE OF \$ 445**

Accounting distribution as follows: (Distribution to be made in General Office.)

	Operating Expenses	Profit and Loss	Net Operating Expenses	Net Profit and Loss
Cost of property retired ... \$	\$	\$	\$	\$
Value of salvage .....				
Incidental costs .....			33	
Total to Operating Expenses .....				\$ 33 ✓
Total to Profit and Loss .....				
To Material and Supplies .....				
To Bills for Collection .....				
To Other Accounts .....				
Net charge to investment account—Additions and Betterments .....				412 ✓
Total of distribution .....				\$ 445 ✓

Budget reference: *not in Budget* Class of Work: No. *17*  
 Joint facility contract reference: *not joint*  
 The location is — on this company's property. To secure rights, it will be necessary  
 Location: Spangle, Washington.

Title 12'x24' addition to agent's dwelling.  
 and  
 Reason: There are eight members of the agent's family at Spangle, mostly small children. The family is living in a small four room cottage 24'x24' outside dimensions, rooms about 11'x11' and they are naturally badly crowded.

There is a space of 30' between the station building and this dwelling and a 12'x24' addition may be made on the depot side of the living rooms, thereby relieving the congested condition. Recommend that this be approved early as practicable.

Original Cost Adjustment  
 Made in JUN 1923

Checked and Entered  
 President's Office



Work to be done by company force under charge of **SUPERINTENDENT**  
 contract  
 Accounting to concentrate in the office of **SUPERINTENDENT**  
 Signature and Title: *W. H. Walter* Date **January 2nd 19 22.**  
**SUPERINTENDENT**

APPROVED:  
*W. H. Walter*  
 General Superintendent. Prin. Asst. Engr. or Engr. Maint. of Way. Assistant General Manager.  
*W. H. Walter* Chief Engineer. *W. H. Walter* General Manager. *W. H. Walter* Vice President.  
*W. H. Walter* For Comptroller. *Charles D. Smith* President. Date of Final Approval } **1 23 22** 19

**COMPTROLLER'S RECORD OF NOTICE OF APPROVAL AND OF COMPLETION**

Form No. 1345 issued **JAN 27 1923** Work begun.....19..... Work finished **Mar 19 19 23**

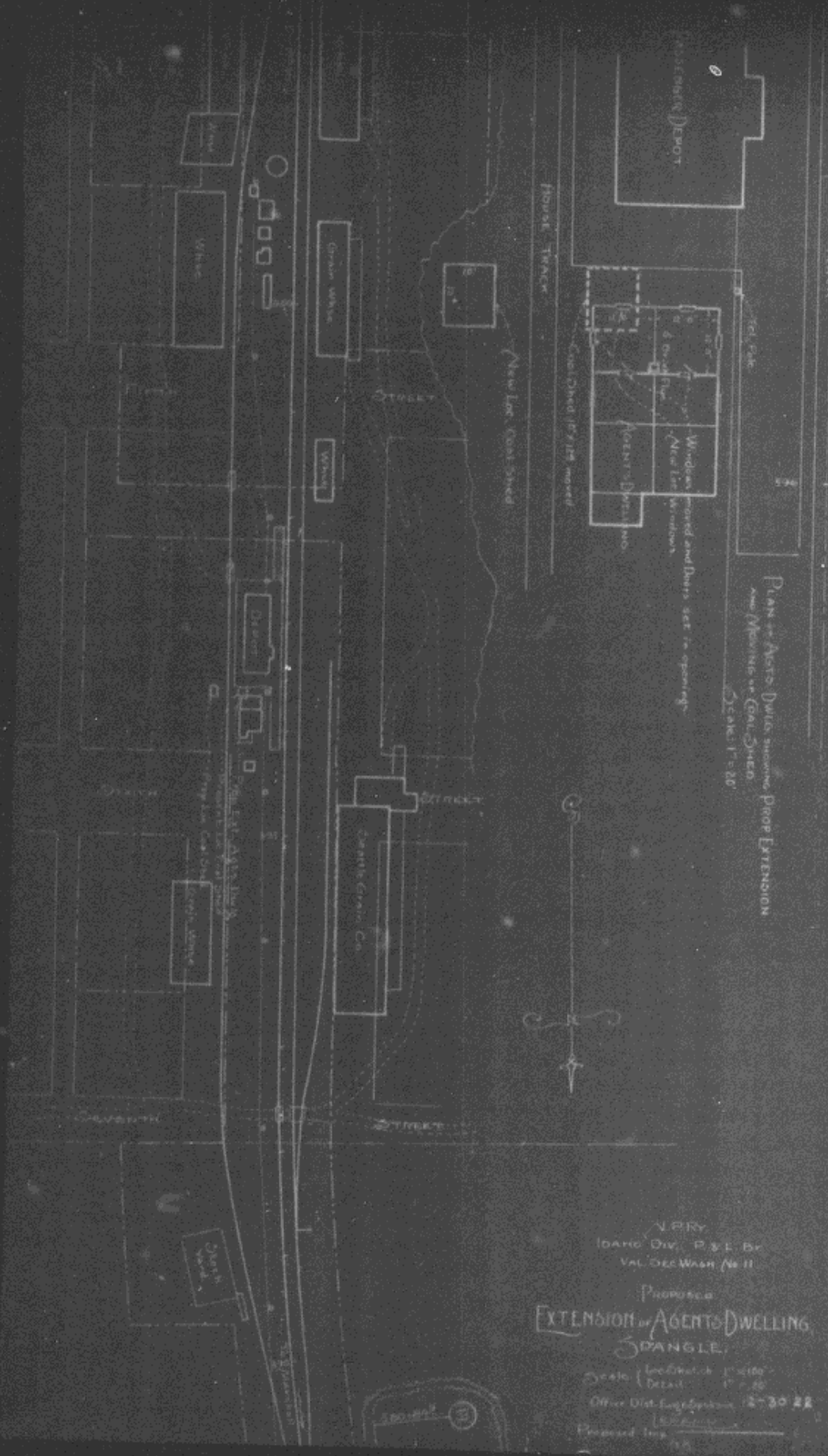

House Track

Plan of Agents Dwelling showing Prop. Extension  
 and Men's and Coal Shed  
 Scale 1" = 20'

V.B.R.Y.  
 Idaho Div. P. & L. Br.  
 VAL DEC WASH No 11  
 Proposed  
 EXTENSION of AGENTS DWELLING  
 SPANGLE  
 Scale (Location) 1" = 40'  
 Detail 1" = 20'  
 Office Dist. Eng. System 12-30-22  
 Proposed Date 12-30-22