

1922

# NORTHERN PACIFIC RAILWAY COMPANY

AUTHORITY FOR EXPENDITURE

Year: 1922

Superintendent's No. 3  
No.

Dept. No. Engineering Dept. No. 13(22)

A. F. E. No. 122

P A B C O Div. Wallula

XXXXXX State Wash. Branch

Val. Sec. No. 1-C

**AUTHORITY IS REQUESTED FOR A NET EXPENDITURE OF \$364.**

Accounting distribution as follows: (Distribution to be made in General Office.)

	Operating Expenses	Profit and Loss	Net Operating Expenses	Net Profit and Loss
Cost of property retired	\$	\$	\$	\$
Value of salvage				
Incidental costs				
Total to Operating Expenses				
Total to Profit and Loss				
To Material and Supplies				
To Bills for Collection				
To Other Accounts				
Net charge to investment account—Additions and Betterments				364
Total of distribution				364

DEPRECIATION DOCUMENT 15100 ENTERED ON EXHIBIT E

Budget reference: *Not in Budget*

Class of Work: No. 16

Joint facility contract reference: *not joint* *Contract dated Sep 15-1921*

The location is \_\_\_\_\_ on this company's property. To secure rights, it will be necessary

Location: BURBANK (near) *Added to John*  
*Value* DEC 1922

Title R. W. Fence for L. Andrus.

Reason: Mr. L. Andrus who owns and leases property adjacent to our right-of-way just west of Burbank has fenced his land on the other three sides, and now requests that the Railway Company provide a fence along its right-of-way, to enable him to graze his stock upon his land, and to avoid stock encroaching upon our tracks.

It is recommended that this fence be provided in accordance with the attached sketch and estimate.

Checked and Entered President's Office



Work to be done by ~~company force~~ *XXXXXX* under charge of Superintendent.

Accounting to concentrate in the office of Division Superintendent.

Signature and Title: *[Signature]* Superintendent Date Jan. 18th 1922

APPROVED: *[Signature]* General Superintendent *[Signature]* Prin. Asst. Engr. or Engr. *[Signature]* Assistant General Manager

Mech. Supt., Supt. Tech. or Signal Engr. *[Signature]* Chief Engineer *[Signature]* General Manager *[Signature]* Vice President

*[Signature]* General Auditor or Comptroller *[Signature]* Charles [unclear] President Date of Final Approval FEB 11 1922 19

COMPTROLLER'S RECORD OF NOTICE OF APPROVAL AND OF COMPLETION

Form No. 1345 issued FEB 14 1922 19 Work begun \_\_\_\_\_ 19 Work finished May 1 1922

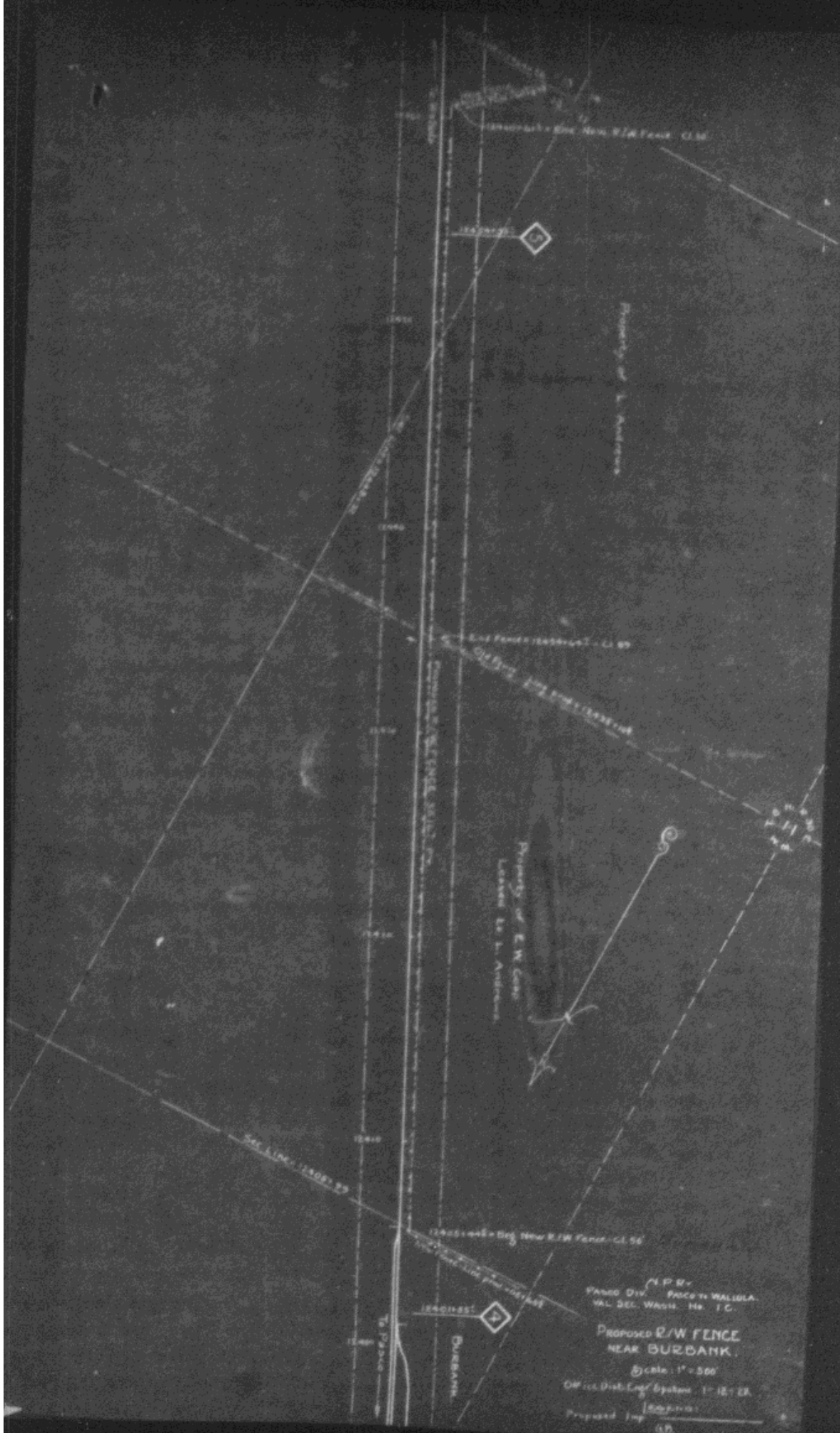

12400-442 = Beg. New R/W Fence - CI 56

12401-442

Property of L. Andrews

End Fence 12458-442 - CI 56

Property of E. W. Cobb  
Leased to L. Andrews

Sec. Line 12402.29

12400-442 = Beg. New R/W Fence - CI 56

12401-442

BURBANK

To Pasco

N.P.R.  
PAVED DIV. PACIFIC RAILROAD  
NAT. SEC. WASH. Ho. T.C.

PROPOSED R/W FENCE  
NEAR BURBANK.

Scale: 1" = 500'

Office Dist. Eng. System - 1" = 10' ER

Proposed by  
G.D.