

1923

# NORTHERN PACIFIC RAILWAY CO.

AUTHORITY FOR EXPENDITURE

Year: 1923

Superintendent's No. 2  
No.

Dept. No. Engineering Dept. No. 29 (23)

A. F. E. NO. 133

Tacoma

Div. Main Line

District State Wash

Val. Sec. No. 6

AUTHORITY IS REQUESTED FOR A NET EXPENDITURE OF \$ 612.

Accounting distribution as follows: (Distribution to be made in General Office.)

	Operating Expenses	Profit and Loss	Net Operating Expenses	Net Profit and Loss
Cost of property retired	\$	\$	\$	\$
Value of salvage				
Incidental costs				
Total to Operating Expenses				
Total to Profit and Loss				
To Material and Supplies				
To Bills for Collection				
To Other Accounts				
Net charge to investment account—Additions and Betterments				1032
Total of distribution				1257
				1889
				\$ 1644

DEPRECIATION ACCOUNT T5180 ENTERED ON EXHIBIT E

Budget reference: Item 250, 1923

Class of Work: No. 10

Joint facility contract reference: G. H. O'NEILL RY } 7-1-09

Adjusted Month OCT 1926

The location is on this company's property. To secure rights, it will be necessary

Location: Centralia, Washington

Track increase 580 feet. Spur to serve the Grange Warehouse Company

Reason: At Centralia the Grange Warehouse Company have recently erected one story brick building 40 x 110 feet adjoining Northern Pacific right of way and W. J. Glover has also erected a one story brick building 110 feet square adjoining building of Grange Warehouse Company, both buildings to be used for general warehouse purposes and storage of freight to be shipped in in carloads via rail. To serve these buildings spur track facilities required. It is estimated that the annual rail revenue W. P. and tenant lines incident to carload shipments to be unloaded at these two warehouses will be at least \$5000. Construction of spur track is recommended on the basis of Northern Pacific assuming expense to clearance point, remainder expense to be assumed jointly by the applicants the Grange Warehouse Company and W. J. Glover as per sketch and estimate herewith attached.

Industrial track agreement Form 802 dated November 15th 1922 is attached.

Work to be done by ~~contract~~ company force under charge of Superintendent

Accounting to concentrate in the office of Superintendent

Signature and Title: *W. A. Bee* Superintendent Date Jan. 2, 1923

APPROVED: *A. P. Brown* General Superintendent. *A. P. Brown* Prio. Asst. Engr. or Engr. in Charge of Work. *A. P. Brown* Assistant General Manager.

Mech. Supt., Supt. of Telegraph or Signal Engr. *W. J. Glover* Chief Engineer. *W. J. Glover* General Manager. *W. J. Glover* Vice President.

For Comptroller. *Charles J. ...* Date of Final Approval 2-2-23 1923

COMPTROLLER'S RECORD OF NOTICE OF APPROVAL AND OF COMPLETION

Form No. 1345 issued FEB 7 1923 Work begun 1923 Work finished Jan. 21, 1923

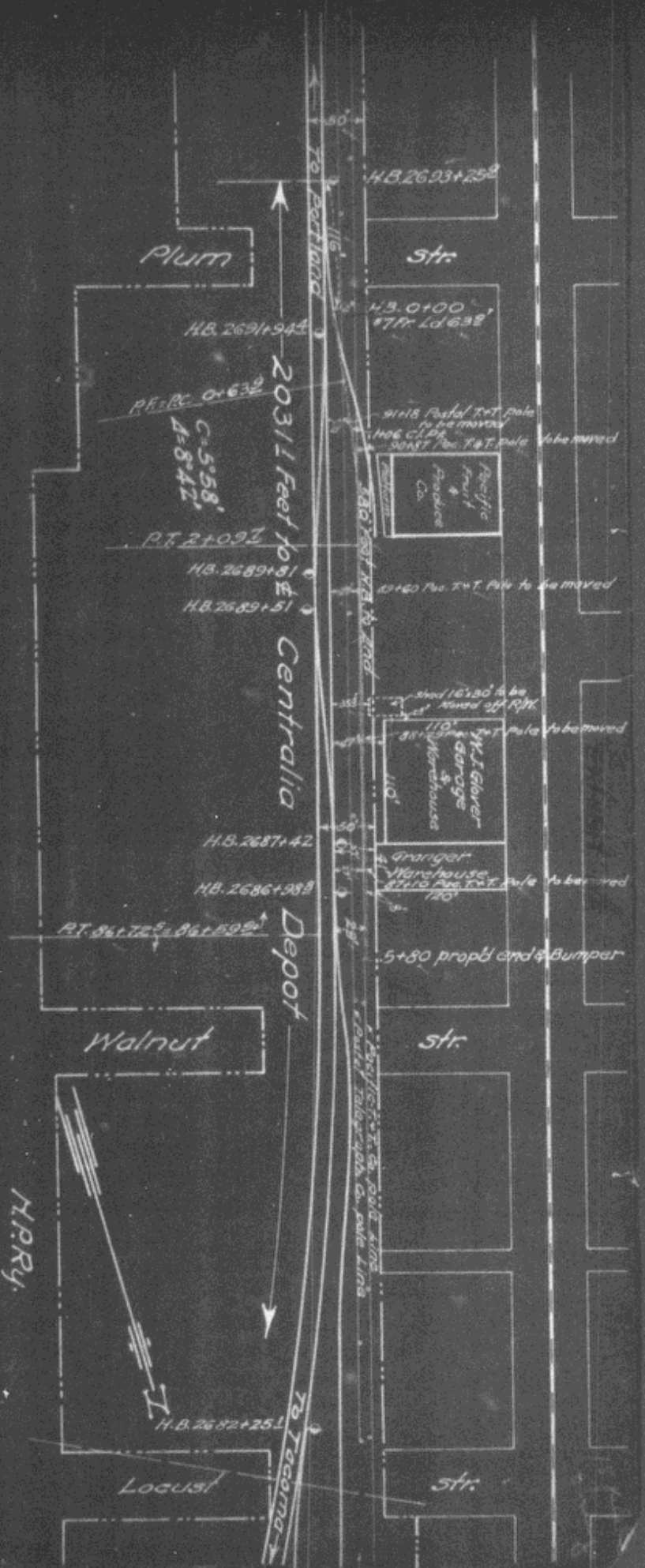
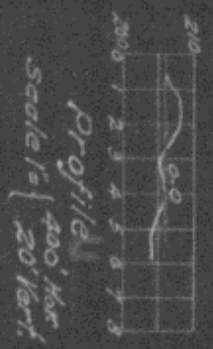

Tacoma Div. Main Line  
 Wash. Vol. Sec. # 6  
 sketch showing proposed spur  
 to serve Oranger Warehouse Co.  
 of  
 Centralia, Wash.  
 office of Dist. Engr. Seattle, Wn.  
 Scale 1" = 100' Dec. 27, 1922

H.P.Ry.