

NORTHERN PACIFIC RAILWAY COMPANY.

Montana

Division.

Auditor's No. 912

Superintendent's No. 75

Livingston, Montana, Nov. 6, 1898. 189

To W. G. Pearce, Esq.,  
Asst. Genl. Superintendent.

I respectfully recommend the improvement described below, and request special appropriation to cover cost of same.

1. Location (with regard to nearest station) Butte East head block ft. West of M. P.

2. Title. (Side Tracks and Spurs to be named) Yard at M. U. Transfer, Butte

3. Description. (Give description of proposed New Work. If Siding or Spur, make Sketch below showing Points of Compass; if Standard Building, no description is necessary, but give Plan Nos.)

See blue print attached. Work contemplated season of 1898, in the south half of yard comprising eleven tracks; total length 17485 track feet.

330

4. New Work, Additions or Repairs. New

5. Necessity for proposed Work: (If increase of Business, give particulars.) New business from Rocky Fork Branch for Butte and Amaconda.

6. Is Improvement on Right-of-way or Land owned by this Company? Not altogether. If not, what can be done to secure Title? Lease Department will acquire title.

7. Estimate of Cost: Material (as itemized on next page) \$2000.00 Labor \$18000.00 Total \$20,000.00

8. Work should be commenced at once in order to Completed by January 1st, 1899.

9. Length of Time required to complete Work Two months

10. Remarks: (Note here if any Material or Labor is to be furnished by outside parties, and whether work should be done by contract or with Company force.)

The above is about one-half the cost of the completed yard. Work to be done by Company force. Copy of letter of authority from Assistant General Superintendent, dated Nov. 2nd, attached hereto.

Chief Engineers Office

11/25/98 3

Chas. Baker

Division Engineer.

A. J. Thompson

Superintendent.

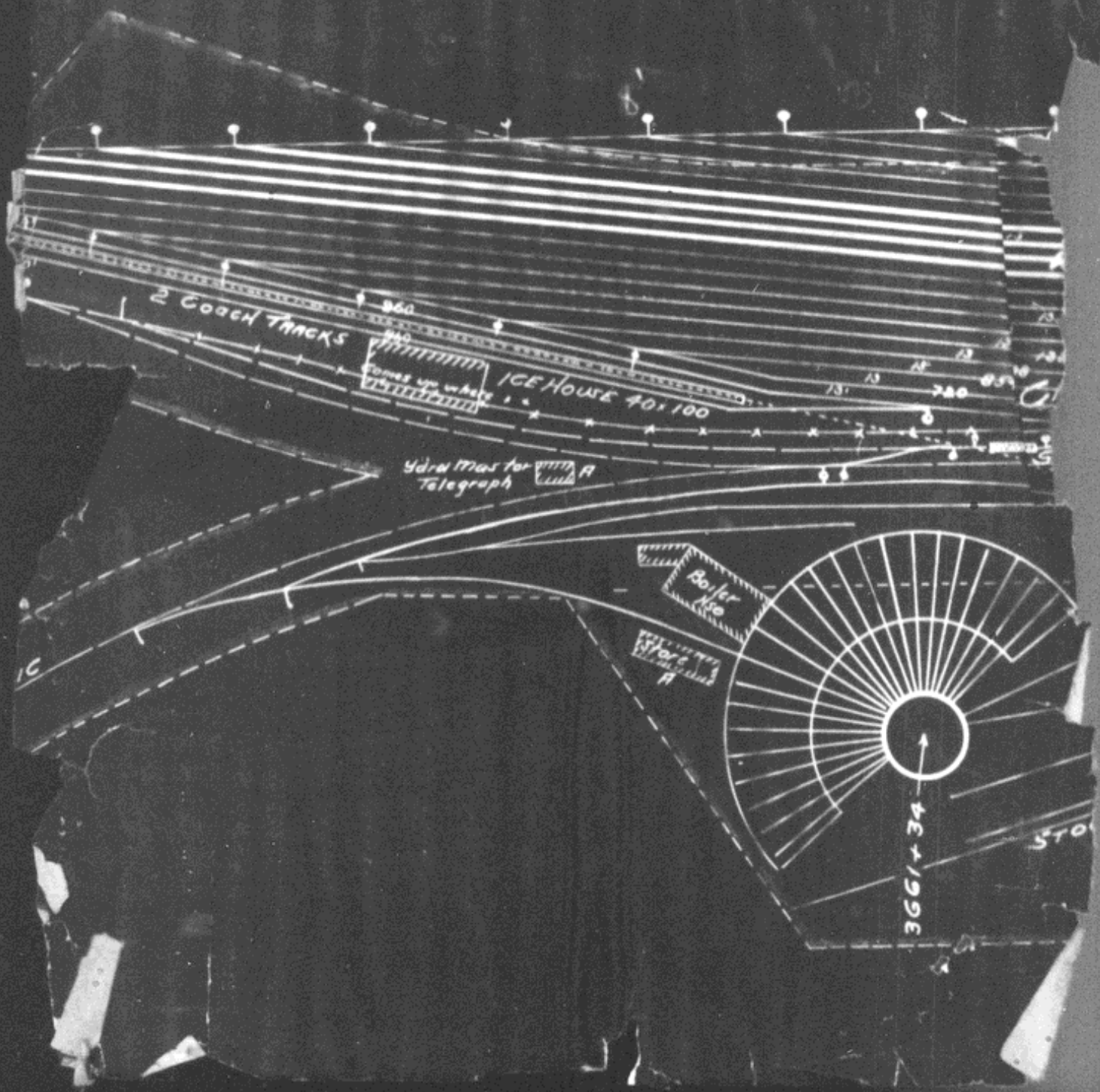

3653-17

1088  
 1550  
 1790  
 2024  
 2250  
 CAPACITY 250 CARS  
 CAPACITY 215 CARS

1550  
 1790  
 2024  
 2250  
 CAPACITY 240 CARS

COAL STA

Stand Pipe - A

TANK

REPAIR TRACKS - A-

WATER YARD TRACK

STOCK YARD

(not to scale)



N P R  
MONTANA DIVISION  
PROPOSED YARD  
BUTTE

SCALE 1" = 100'

LIVINGSTON 10-21-98

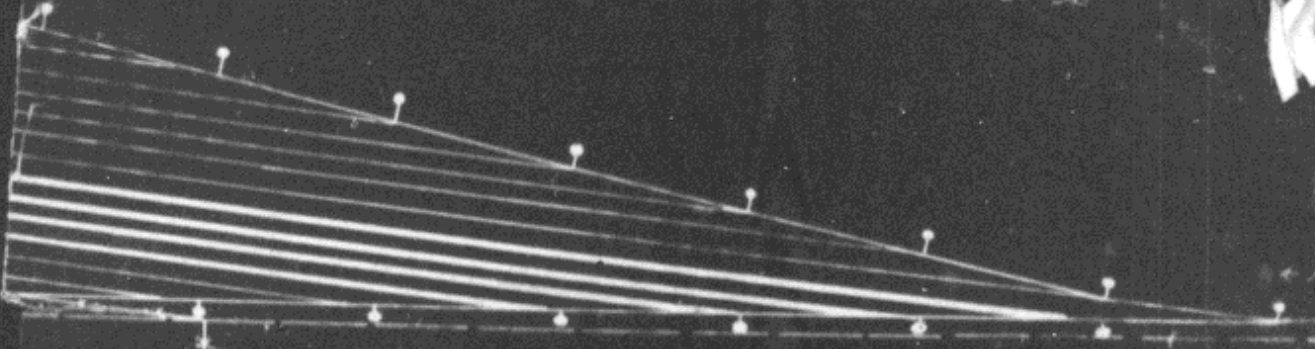

STREET CAR LINE 3641+98  
NOTE MAIN TRACK NP  
3660-43 ON 9/10 grade  
3643-3589 " 125'

8717' TO MONTANA UNION  
TO MONTANA UNION  
1135'  
01109 12' CURVE

BRIDGE 87 ← TO NORTHERN  
UP TOWN