

691 12/6

NORTHERN PACIFIC RAILWAY COMPANY.

Auditor's No. 913

Montana

Division.

Superintendent's No. 76

Livingston, Montana, Nov. 8th 1898 189

To **W. G. Pearce, Esq.,**
Asst. Genl. Superintendent.

I respectfully recommend the improvement described below, and request special appropriation to cover cost of same:

1. Location (with regard to nearest station) **P.P. Junction** East head block _____ ft. West of M. P. _____
2. Title. (Side Tracks and Spurs to be named) **Coke Spur #2 - 530'**
3. Description. (Give description of proposed New Work. If Siding or Spur, make Sketch below showing Points of Compass; if Standard Building, no description is necessary, but give Plan Nos.)

See Blue Print attached.

4. New Work, Additions or Repairs. **New**
5. Necessity for proposed Work: (If increase of Business, give particulars.) **to enable Smelter Company to increase storage capacity of its coke bins.**

6. Is Improvement on Right-of-way or Land owned by this Company? No. **U.S. & R. CO.**
If not, what can be done to secure Title? **Will furnish easement**

7. Estimate of Cost: Material (as itemized on next page) **\$182.00** Labor **B/C** Total **\$182.00**

8. Work should be commenced **at once** in order to **accommodate shipments of Coke.**

9. Length of Time required to complete Work **Three weeks**

10. Remarks: (Note here if any Material or Labor is to be furnished by outside parties, and whether work should be done by contract or with Company force.)

Per correspondence attached, the United Smelting & Refining Co. agree to assume the entire expense (less rail which I have assumed the N. P. R'y Co. prefer to own) estimated at as below.

TRACK:	Labor	\$50.00		
	Material	88.00	\$ 138.00	
BRIDGING:	Labor	744.00		
	Material	945.00	1689.00	\$1827.00

Chief Engineers Office

11/25/98 3

[Signature]
Division Engineer

[Signature]
Superintendent

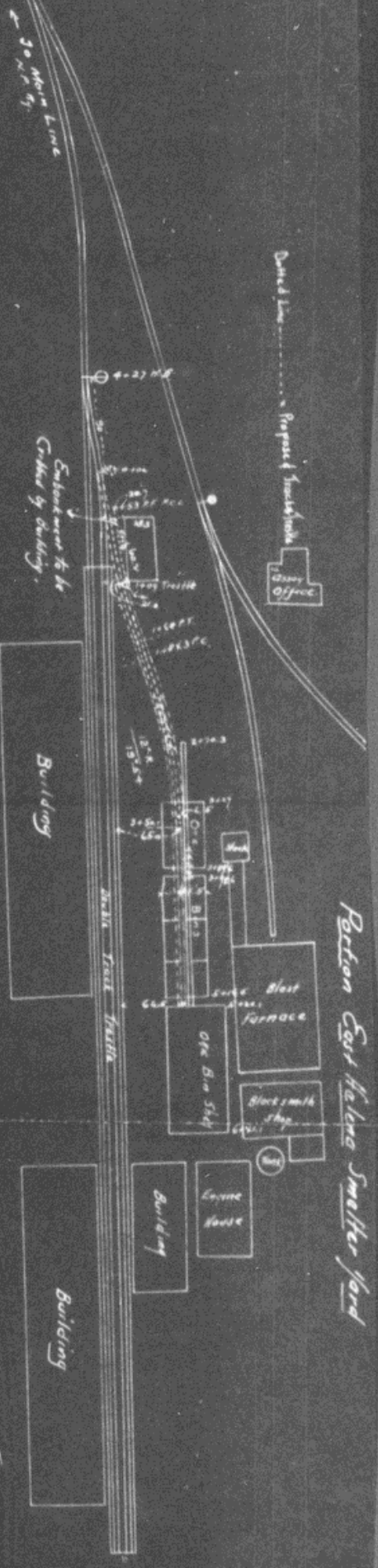

Portion East Helene Smelter Yard

Note
The United S. & F. Co. ore to build work satisfactory to U. Co. or else move City and make on end.

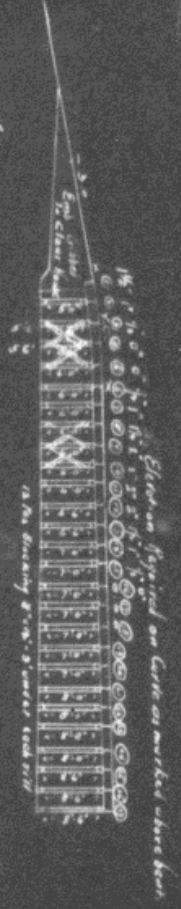

Dimensions figured on corners as marked where built

Proposed South

Pages of the United Smelting & Refining Co. Engineers

Wheat Ave
New York City
E. J. Cantine P.S.

Item	Quantity	Unit Price	Total
Timber	2750	1.25	3437.50
Iron	100	10.00	1000.00
Steel	500	2.00	1000.00
Concrete	1000	1.00	1000.00
Brick	10000	0.10	1000.00
Plaster	1000	1.00	1000.00
Paint	100	1.00	100.00
Other	100	1.00	100.00
Total			9975.00

Bill of Material

Item	Quantity	Unit Price	Total
Steel	500	2.00	1000.00
Iron	100	10.00	1000.00
Concrete	1000	1.00	1000.00
Brick	10000	0.10	1000.00
Plaster	1000	1.00	1000.00
Paint	100	1.00	100.00
Other	100	1.00	100.00
Total			1007.00