

NORTHERN PACIFIC RAILWAY COMPANY.

Pacific Division.

Inspector's No. 796

Superintendent's No. 100

June 29th 1895

To *Mr. H. G. Pearce*
Asst. Genl. Supt.

I respectfully recommend the improvement described below, and request special appropriation to cover cost of same:

1. Location (with regard to nearest station) *Palmer East head block 365 ft. West of M. P. 212*
2. Title. (Give Tracks and Spurs to be named) *Occidental coal bin spur*
3. Description. (Give description of proposed New Work. If siding or spur, make sketch below showing Points of Compass; if Standard Building, no description is necessary, but give Plan Nos.)

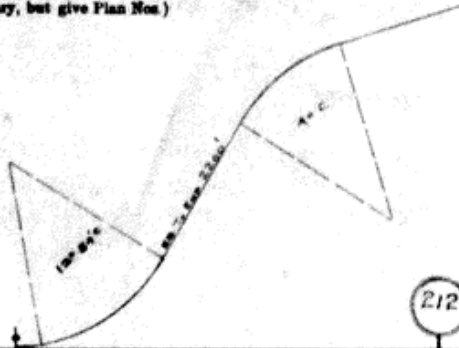

4. New Work, Additions or Repairs *New Work*

5. Necessity for proposed Work: (If increase of Business, give particulars.)

6. Is Improvement on Right-of-way or Land owned by this Company? *No.*

Not If not, what can be done to secure Title? *None necessary. Coal to be covered all material in track.*

7. Estimate of Cost: Material (as itemized on next page) Labor Total

8. Work should be commenced *at once* in order to *accommodate ship getting out back*

9. Length of Time required to complete Work *3 Weeks*

10. Remarks: (Note here if any Material or Labor is to be furnished by outside parties, and whether work should be done by contract or with Company force.)

Owner to pay all expenses including material

<i>Steel and Fastenings</i>	<i>694.00</i>
<i>Iron</i>	<i>281.00</i>
<i>Grading</i>	<i>675.00</i>
<i>Painting & surfacing Track</i>	<i>265.00</i>
<i>City & Exp</i>	<i>20.00</i>
	<i>1935.00</i>

Shael Bihler Division Engineer.

7/5 1895

Chief Engineers Office

[Signature] Superintendent.

9/26/95