

**NORTHERN PACIFIC RAILWAY COMPANY**  
**AUTHORITY FOR EXPENDITURE**

Year: **1922**

Superintendent's No. **164** Dept. No. **100(21)**  
 No. Engineering Dept. No. **100(21)**

A.F.E. NO. **02**

Tacoma Div. **Main Line** District State **Wash** Val. Sec. No. **6**

**AUTHORITY IS REQUESTED FOR A NET EXPENDITURE OF \$1093.**

Accounting distribution as follows: (Distribution to be made in General Office.)

	Operating Expenses	Profit and Loss	Net Operating Expenses	Net Profit and Loss
Cost of property retired	\$	\$	\$	\$
Value of salvage				
Incidental costs				
Total to Operating Expenses				
Total to Profit and Loss				
To Material and Supplies				
To Bills for Collection				
To Other Account				
Net charge to investment account—Additions and Betterments				1093
Total of distribution				\$ 1093



Budget reference: *Not in Budget*

Class of Work: No. **4**

Joint facility contract reference: **G. N. Ry } 7-1-09**  
**OWREN**

The location is *on* this company's property. To secure rights, it will be necessary *to acquire title*

Location: **Vader, Washington**

Title and Reason: **Riprap placed around east pier Bridge #78**

Reason: On double track Main Line between Vader and Olequa high water in October 1921 in Olequa Creek washed out an old dam above Bridge 78 on westward track causing water to cut around east pier endangering bridge. Protection was afforded by placement of thirteen cars riprap to protect pier. This RPA submitted to cover cost of work completed October 31st 1921.

Checked and Entered  
 President's Office



Work completed October 31st 1921

Work to be done by ~~company~~ ~~contract~~ under charge of

Superintendent

Accounting to concentrate in the office of

Superintendent

Signature and Title: *[Signature]* Date **Dec. 16** 19**21**

<i>[Signature]</i> General Superintendent.	<i>[Signature]</i> Assistant General Manager.
<i>[Signature]</i> Mech. Supt. or Supt. Telg.	<i>[Signature]</i> Vice President.
<i>[Signature]</i> Chief Engineer.	<i>[Signature]</i> General Manager.
<i>[Signature]</i> Comptroller.	<i>[Signature]</i> President.

Date of Final Approval } **JAN 23 1922** 19

**COMPTROLLER'S RECORD OF NOTICE OF APPROVAL AND OF COMPLETION**

Form No. 1345 issued **JAN 24 1922** 19 Work begun 19 Work finished **Nov. 1 1921**

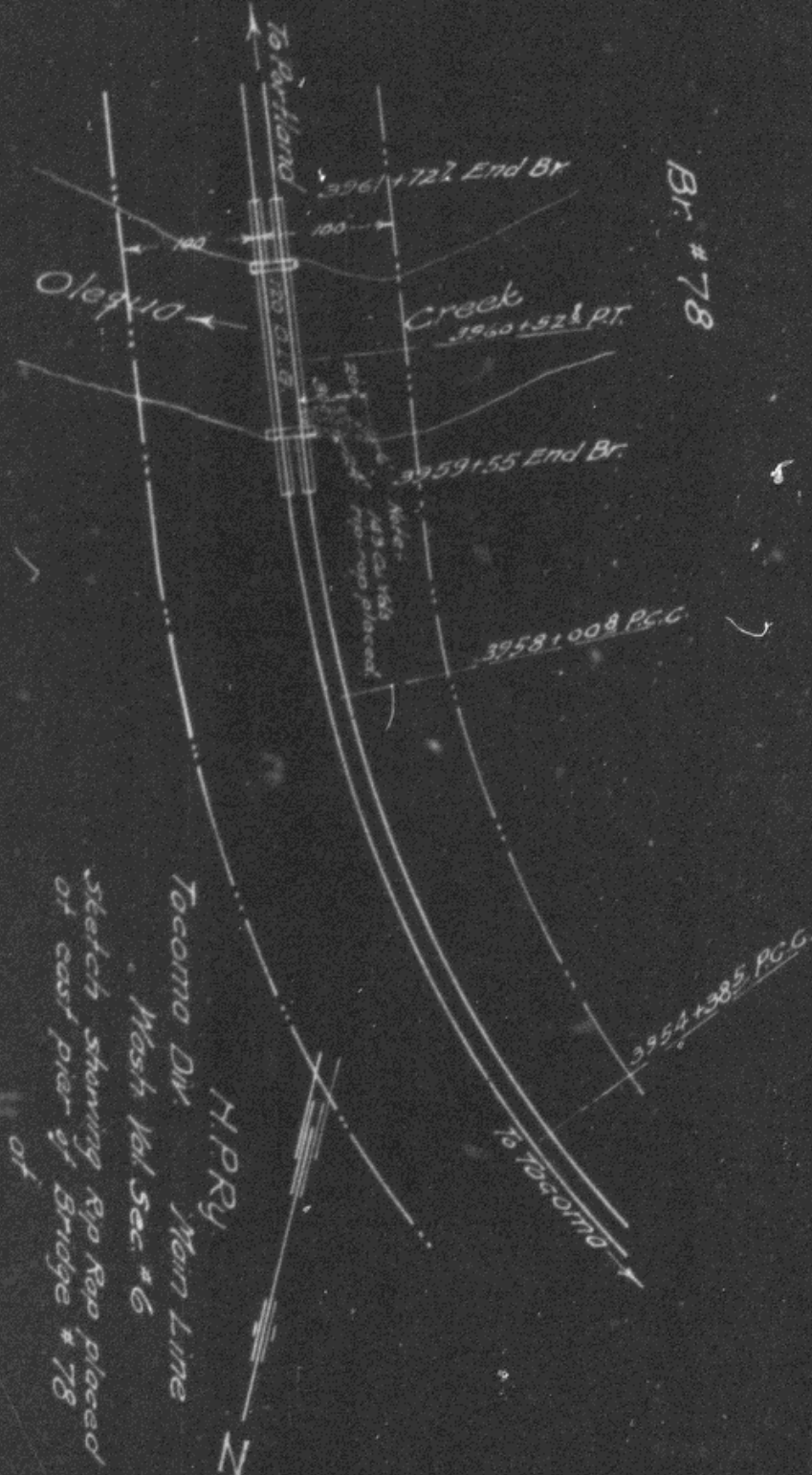

Br # 78

H.P.R.Y.  
 Tocomo Div. Main Line  
 Mash Val. Sec. #6  
 Sketch showing rip rap placed  
 on east pier of Bridge # 78  
 of  
 WADER, WASH.  
 Office of Dist. Engr. Tocomo, W.I.  
 Scale 1"=100' Dec 10, 1921