

NORTHERN PACIFIC RAILWAY COMPANY  
 AUTHORITY FOR EXPENDITURE

Year: 1922 **1923**

Superintendent's No. **117** Dept. No. **Engineering Dept. No. 12(23)**  
 No. **DAHO** Div. **SECOND** District State **WASH** Val. Sec. No. **1-B**  
 Branch

A. F. E. No. **84**

AUTHORITY IS REQUESTED FOR A NET EXPENDITURE OF \$ 445

Accounting distribution as follows: (Distribution to be made in General Office.)

	Operating Expenses	Profit and Loss	Net Operating Expenses	Net Profit and Loss
Cost of property retired . . . \$		\$ 10000	\$	\$
Value of salvage . . . . .	100	115	100	9885
Incidental costs . . . . .			55	605
Total to Operating Expenses . . . . .				\$ 45
Total to Profit and Loss <b>Acct. 619, Loss on Retired Road &amp; Equipment</b> . . . . .				10490
To Material and Supplies . . . . .				215
To Bills for Collection . . . . .				
To Other Accounts . . . . .				
Net charge to investment account—Additions and Betterments . . . . .				10000
Total of distribution . . . . .				\$ 660



Budget reference: *not in Budget* Class of Work: No. **17**  
 Joint facility contract reference: *not joint*

The location is \_\_\_\_\_ on this company's property. To secure rights, it will be necessary

Location: **Spokane, Washington.**

Title **Dismantling old ice house.**

Reason: A large portion of the Spokane old ice house was destroyed by fire on the morning of May 21, 1920. The fire was caused by a gasoline tank exploding due to a chain slipping on the hoist, which was being used for elevating sawdust into the house for covering the ice. This broken chain knocked a hole in the tank and the gasoline running out, became ignited at the engine exhaust. The explosion occurred in the east end of the house the flames spreading rapidly to the east four sections of the ice house which were completely destroyed. The west end of the ice house, sections 5 and 6 and the extreme west end portion which was used as a B&B Department carpenter shop, were not damaged.

To protect the exposed ice in the burned sections of the ice house, a temporary shelter was erected over the ice. We have since constructed the new ice house at Spokane under AFE 1717-20 which we filled with ice last winter to protect this season's icing. To fill up all available space, it was decided during the last harvest that additional ice be packed in the remaining sections of the old house and the temporary addition thereto. Ice was accordingly stored in 97' of the temporary section and 236' of the old house as shown on the attached print. The balance of this building was removed under informal authority of the General

Work to be done by company force under charge of contract Superintendent Checked and Entered President's Office  
 Accounting to concentrate in the office of Superintendent

Signature and Title: *[Signature]* Date **Dec. 19th** 1922  
 Superintendent

APPROVED: <i>[Signature]</i> General Superintendent.	<i>[Signature]</i> Prin. Asst. Engr. or Engr. Maint. of Ways	<i>[Signature]</i> Assistant General Manager.
<i>[Signature]</i> Mech. Supt., Supt. Tel. or Signal Engr.	<i>[Signature]</i> Chief Engineer.	<i>[Signature]</i> General Manager.
<i>[Signature]</i> For Comptroller.	<i>[Signature]</i> President	<i>[Signature]</i> Vice President.

COMPTROLLER'S RECORD OF NOTICE OF APPROVAL AND OF COMPLETION

Form No. 1345 issued **JAN 30 1923** 1923 Work begun \_\_\_\_\_ 1923 Work finished **Jan 30 1923**

Ice house proposed to be removed

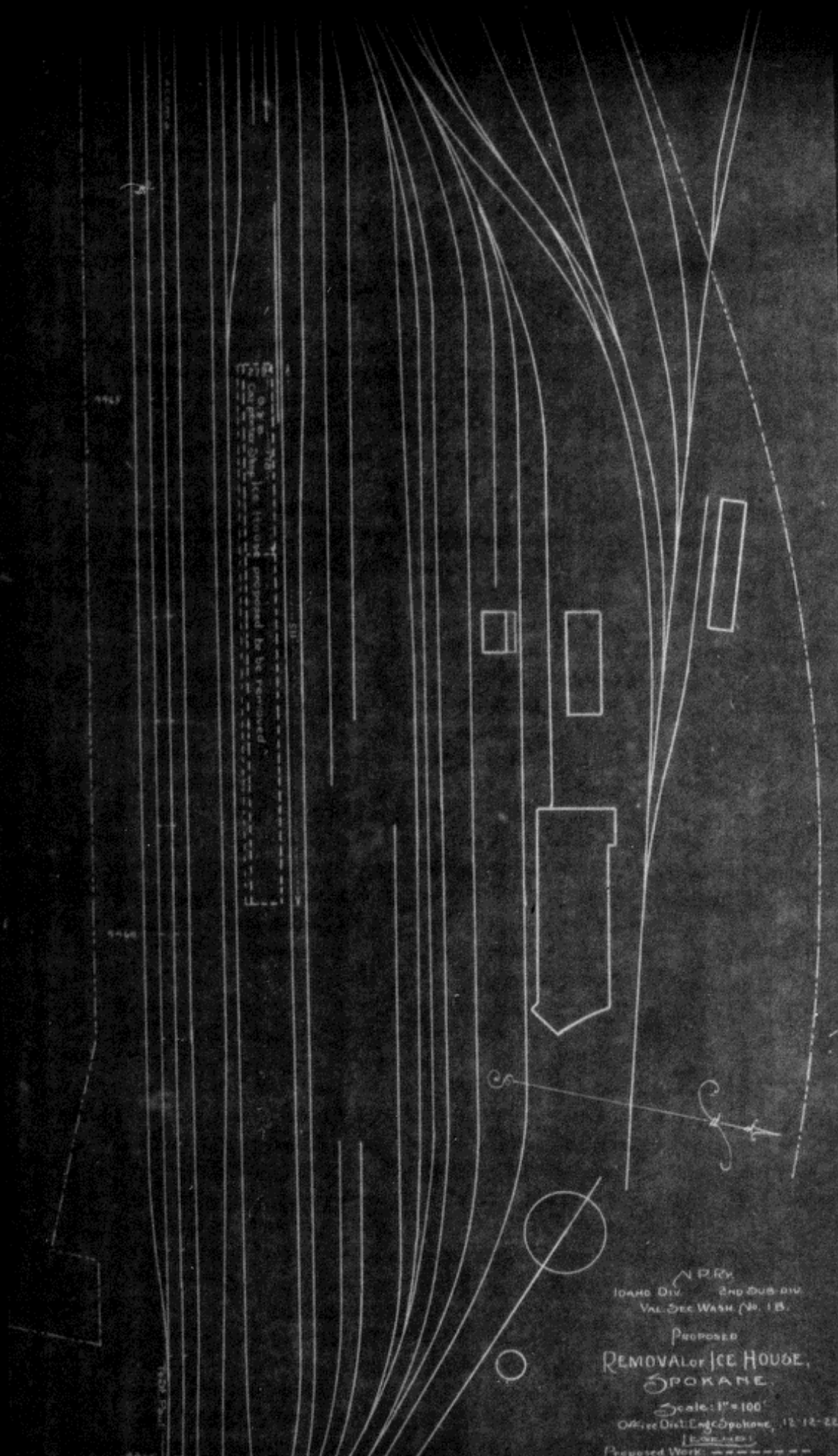

N.P.R.  
10400 Div. 2nd Sub Div.  
Val. Sec Wash No. 1 B.

PROPOSED  
REMOVAL OF ICE HOUSE,  
SPOKANE.

Scale: 1" = 100'  
Office Dist. Eng. Spokane, 11-12-22.  
Proposed Work: -----  
4B