

Where Used	A	B	C	D	E	F	G	H	J	K
3-HP Fairmont Engine	3 3/4"	19 3/4"	33 3/4"	36 3/4"	8"	15"	3 5/8"	23 1/2"	31 1/8"	36 3/4"
4-HP Fairmont Engine										
5-HP Fairmont Engine	7 1/4"	21 1/2"	28"	42 1/2"	9"		8 1/4"	28 1/2"	5 5/8"	42 1/4"
6-HP Fairmont Engine		22 1/2"								

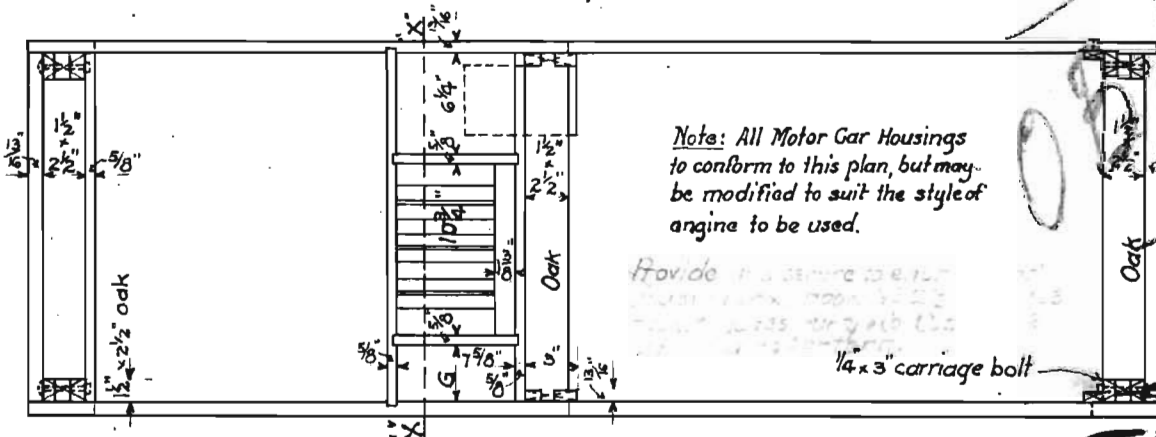

N. P. Ry.
Standard Plan
of Track Tools.
Motor Car Housing.

Scale: - 1" = 1'-0"
 August 12th 1915.

[Signature] General Manager
[Signature] General Manager
[Signature] Chief Engineer, M. of W.
[Signature] First Vice President.